

- Photoelectric proximity sensors, energetic
- Large scanning distance
- Red light as alignment aid
- Adjustable sensitivity
- LED indicator: switching output active and operation reserve
- Material optionally made of plastic or metal

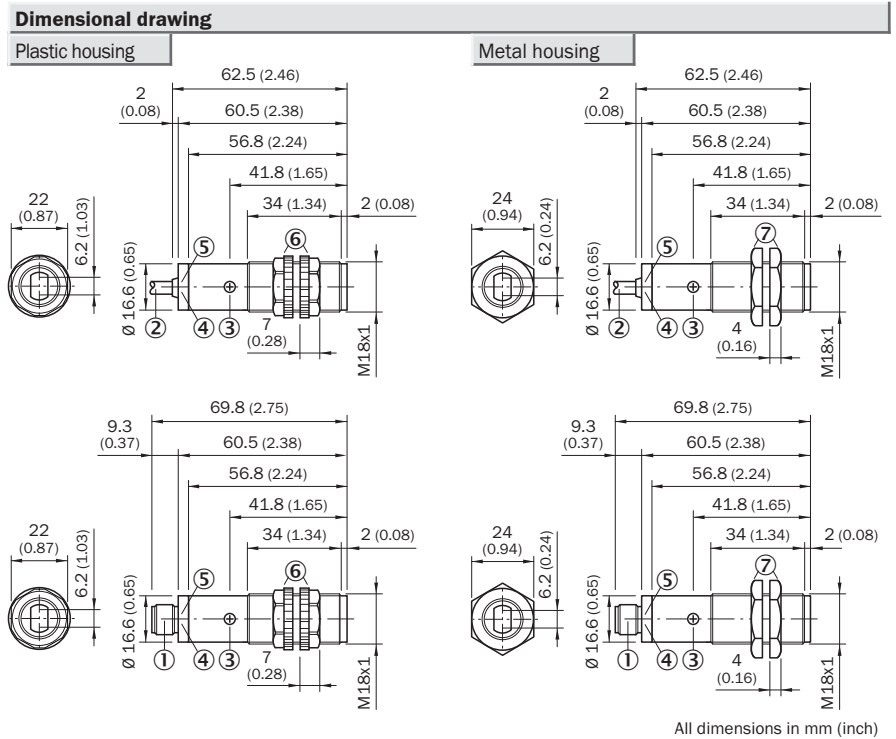

#### Adjustments

All types

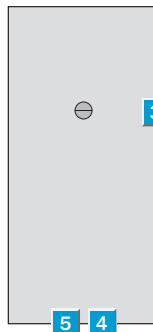

- ① M12 plug, 4-pin
- ② Connector cable 2 m
- ③ Sensitivity control 270°
- ④ Orange LED indicator: switching output active
- ⑤ Green LED indicator, stability indicator:
  - LED lights continuously: light reception < 0.9 / > 1.1
  - LED off: light reception > 0.9 ... < 1.1
- ⑥ Plastic housing, mounting nuts (2x); SW22, PC
- ⑦ Metal housing, mounting nuts (2x); SW24

#### Connection types

VTE180-2N42487	VTE180-2N41187
VTE180-2P42487	VTE180-2P41187
VTE180-2N42482	VTE180-2N41182
VTE180-2P42482	VTE180-2P41182

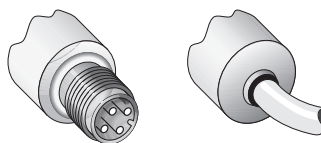

4-pin, M12

4 x 0.18 mm<sup>2</sup>

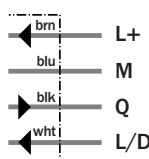
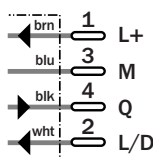

#### Accessories

Cables and connectors  
Mounting systems